

GILLESPIES

LANDSCAPING

01 CONCEPTS

This vision of the Thames has a rich history of timber docks, moorings and harbours that have successfully articulated the river edge. The site was also the location of an outfall water from a mill pond that served a series of flour mills in the neighbourhood. The still, calm areas of protected water in the mill ponds would have contrasted with the busy river scene.

The public open space provision within the Tideway Wharf development will take clues from these past uses to develop a unique landscape design language of water, paving and planting.



The water mills and the mill ponds have influenced the landscape design of the spaces between buildings. The particular romantic quality of a mill pond landscape were captured and subsequently translated into the open spaces of the residential courtyards with the introduction of water canals, water walls and lawn areas and tree planting.

The presence of the river and the existing level difference across the site provides the opportunity to develop a distinctive public landscape identity using the analogy of tidal movements and the exposure of the river bed. This will be expressed by a series of large 'pebbles' of nature emerging out of a unifying pavement that can accommodate a range of activities.



02 OUR RESPONSE TO PLANNING POLICY

The O&MFI strategy for the site proposes the introduction of an accessible green open space on the Nine Elms Lane corridor. The Tideway Wharf Landscape Strategy proposes to locate this space around the existing inlet dock. This new pocket park will provide a fully accessible connection between the river and Nine Elms Lane that could eventually link to other key areas of open space that are under consideration in the wider masterplan.



"The opportunity for new publicly accessible connections to the river has been a vital consideration in the development of the scheme."

03 THE PROPOSED LANDSCAPE MASTERPLAN

The diagram below identifies the individual elements that make up the landscaping on the site. These are further explained on the following boards...



04 PLAY ON THE WAY

The landscape masterplan aims to create a Play Strategy that will respond to current best practice guidelines for play, including the London SPG 'Providing for Children and Young People's Play' and 'Play England's Design for Play'. A guide to creating successful play spaces.

The masterplan recognises the concept of a 'Playable Router' or 'Play on the Way' where opportunities for informal play are woven into the proposed public spaces rather than providing stand alone fenced off play areas. Natural landscape elements will be integrated within designated settings to provide a flexible, high quality public realm to be shared by all generations throughout the day. The concept of 'Play on the Way' could extend along the proposed publicly accessible area alongside Nine Elms Lane culminating in the large pocket park and along the active riverwalk as pockets of activity at the end of each courtyard.



05 POCKET PARK & NINE ELMS LANE INTERFACE

The opportunity exists in the masterplan to create a series of engaging open space environments that will attract pedestrians into the development and provide unimpeded access to the newly landscaped river frontage. The two key areas of open space are the linear park running alongside Nine Elms Lane and the proposed pocket park that occupies the open space between Nine Elms Lane and the inlet dock.

Key objectives of the pocket park landscape are:

- Strategic location opposite the green link that is currently indicated in the O&MFI document to create clear sight lines to the river walk.
- Large scale soft landscaped elements to provide opportunities for passive recreation and viewing.
- Unimpeded access for all abilities by means of hard paved slopes and gentle level changes.
- A language of paving and soft landscape similar to the linear park that unifies the two spaces.
- Large scale tree planting programme that identifies the space as a public park and provides an attractive human scale.
- Strong relationship with the active edges at ground level in the two adjoining buildings.



06 RESIDENTS' GARDENS

The residential spaces are expressed as long green corridors that provide meaningful amenity space as well as natural edges for privacy.

The theme of water is used to articulate the spaces between the buildings. The openings can be seen as areas where the Thames encroaches into the site and where water flows. The water would be expressed in a calm way - very shallow site ponds that provide a visual connection to the river and are reminiscent of mill ponds. The site ponds provide a clear threshold between collective landscape on the river edge and private inner landscapes between the buildings. Trees will be used carefully in the courtyards to humanise the landscape, provide shelter, shade and the delight of seasonal interest. Landform will be used in the inner space to create a particular playful amenity spaces for the residents.



"The presence of the river and the existing level difference across the site provides the opportunity to develop a distinctive public landscape identity using the analogy of a tidal movements and the exposure of the riverbed"

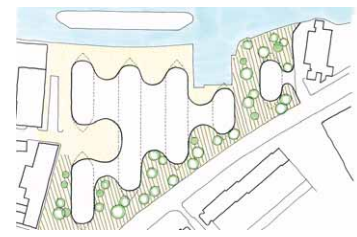

07 RIVERWALK

The riverside experience will consist of a wide unobstructed public walkway with views along the river furthering the aspiration of the O&MFI to eventually re-open the riverwalk to the Battersea Power Station site.

This public open space will be characterised by durable hard materials appropriate to its location and history. However, many opportunities arise within the proposed plan to subtly articulate the space along the building edge. The spaces at the end of each courtyard could see the introduction of green pockets of activities as moments of relief from the busy riverwalk.

"The intention is to provide a freely accessible and permeable environment to encourage visitors from the wider area as well as the existing boat community and new residential community to explore the spaces, rest and recreate."

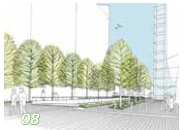

08 WESTERN EDGE INTERFACE

The proposed landscape design of the western edge of the development aims to balance pedestrian accessibility to the river frontage with the creation of a distinctive arrival point and drop off for visitors.

The green corridor defined on the O&MFI is a key pedestrian link from Nine Elms Lane to the River and will be celebrated as a large tree avenue with moments of relief under the tree canopy with bench seating and interesting planting beds. The aim is to soften the visual quality of the space without obstructing pedestrian movement and view lines as well as limiting vehicular crossings. By limiting the vehicular movement in its centre, Kirling Street appears to become a high quality space that would benefit the overall visual quality of the environment. A discreet and integrated ramp will take vehicles from Kirling Street into the Tideway Wharf basement and not interfere with the strong pedestrian movement along the building edge. This allows activities on both sides at ground floor level to develop and spill out onto these pedestrian friendly spaces.

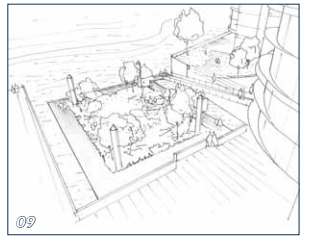

09 INLET DOCK

There is an opportunity to create an event which stimulates interest in the river and provide some amenity space within the existing inlet dock.

The quality of that area with the water coming and going and the relief in the dock wall should be celebrated as a space where people could be in contact with the water and nature. One of the options we are considering is to introduce a large floating garden that would follow the tidal movement similar to the boat landscape community around the site. This space could be accessible from the riverwall via a series of pontoons. The inner green space could see the introduction of urban agriculture for the residents or local schools and communities, ecological gardens that could further enhance the offer of sustainability and biodiversity or a greenhouse pavilion. This is only one suggestion and we would welcome your views on other alternatives.

